

Modular Rake Components

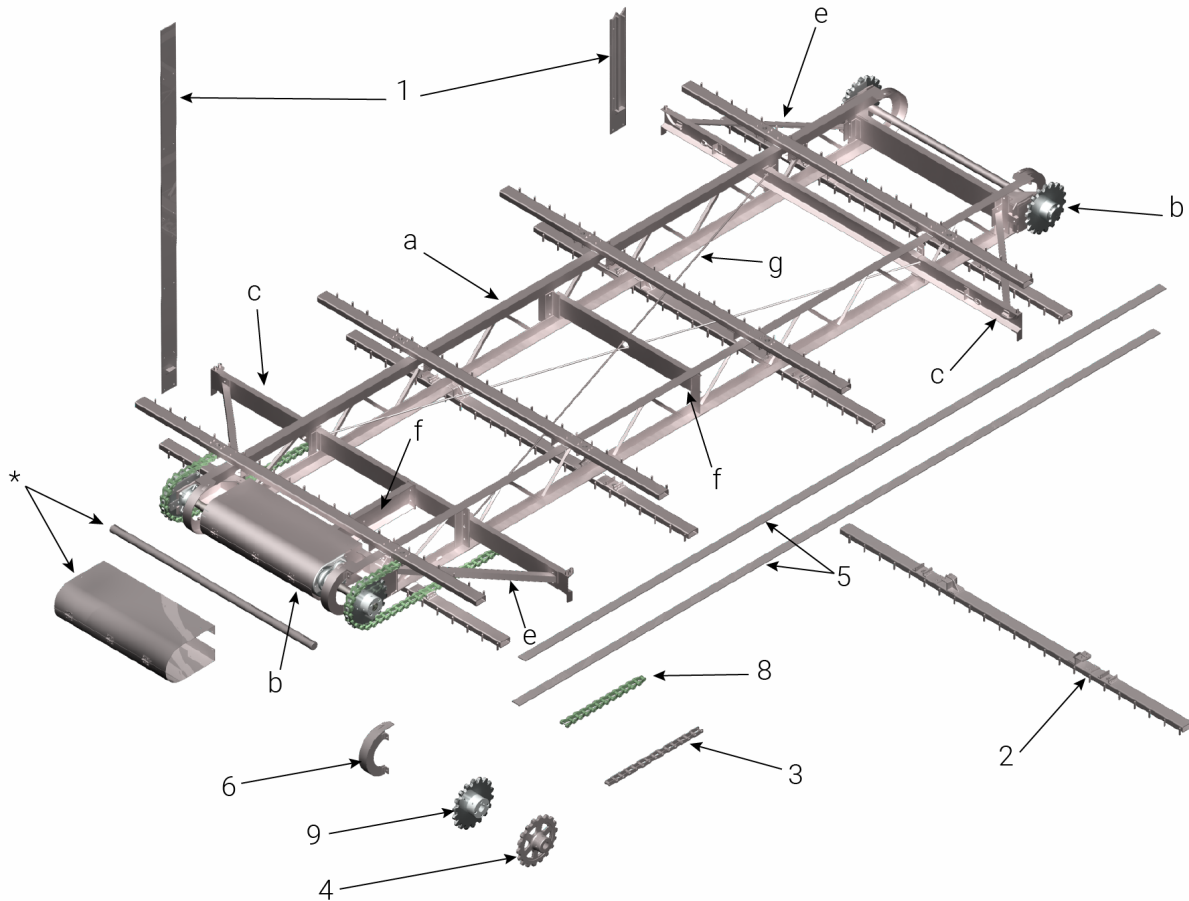

Standard Rake Components

SMR & LMR Rakes

- All major components galvanized
- Plastic rake chain
- Plastic drive and idle sprockets
- Drive shaft & guard in stainless steel*

JMR & HMR Rakes

- All major components galvanized
- Galvanized rake chain
- Galvanized drive sprocket
- Plastic idle end sprockets
- Drive shaft & guard in stainless steel*

GMR & FMR Rakes

- All major components galvanized
- Galvanized rake chain
- Galvanized drive and idle end sprockets
- Drive shaft & guard in stainless steel*

Optional Stainless Steel Components

1. Wear and thrust plates
2. Rake flights
3. Rake chain
4. Drive and idle sprockets
5. Truss covers
6. Rake shoes
7. **Structural Rake Assembly includes:**
 - a) rake frame
 - b) drive and idle ends
 - c) lifting channels
 - d) lifting cables and pulleys (not shown)
 - e) braces
 - f) cross supports
 - g) tie rods
8. Plastic rake chain with SS pins (SMR & LMR Rakes only)
9. Plastic drive and idle end sprockets (use with plastic rake chain)

SS Components not shown

- Bin liners (not shown)
- Hoist drip pan (not shown)
- Bin door (not shown)

Notes

- Stainless steel components - type 304
- Plastic sprockets - UHMW Polyethylene
- Plastic rake chain - FDA compliant polymetric